

Identificar a direcção de abertura da porta /  
Check the opening direction of the door

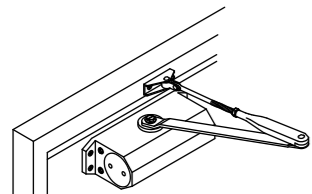

Porta direita /  
Right handed door

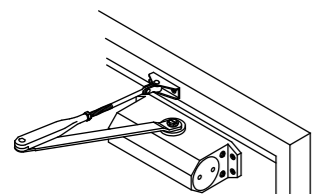

Porta esquerda /  
Left handed door

Suporte do braço /  
Link shoe

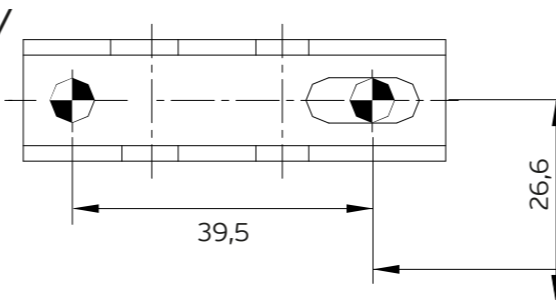

Força menor de fecho /  
Weaker closing force

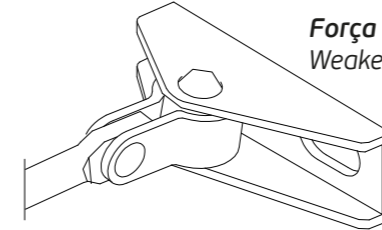

Força maior de fecho /  
Stronger closing force

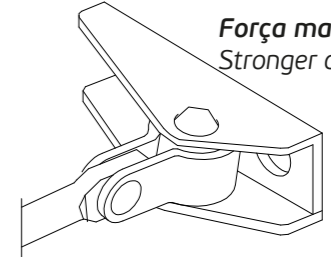

Alinhar pelo aro /  
Align to door frame

Alinhar pelo topo da porta /  
Align to top of door

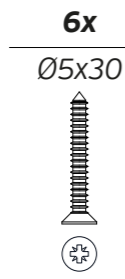

Usar este lado do esquema para portas esquerdas /  
Use this side of template for left hand opening doors

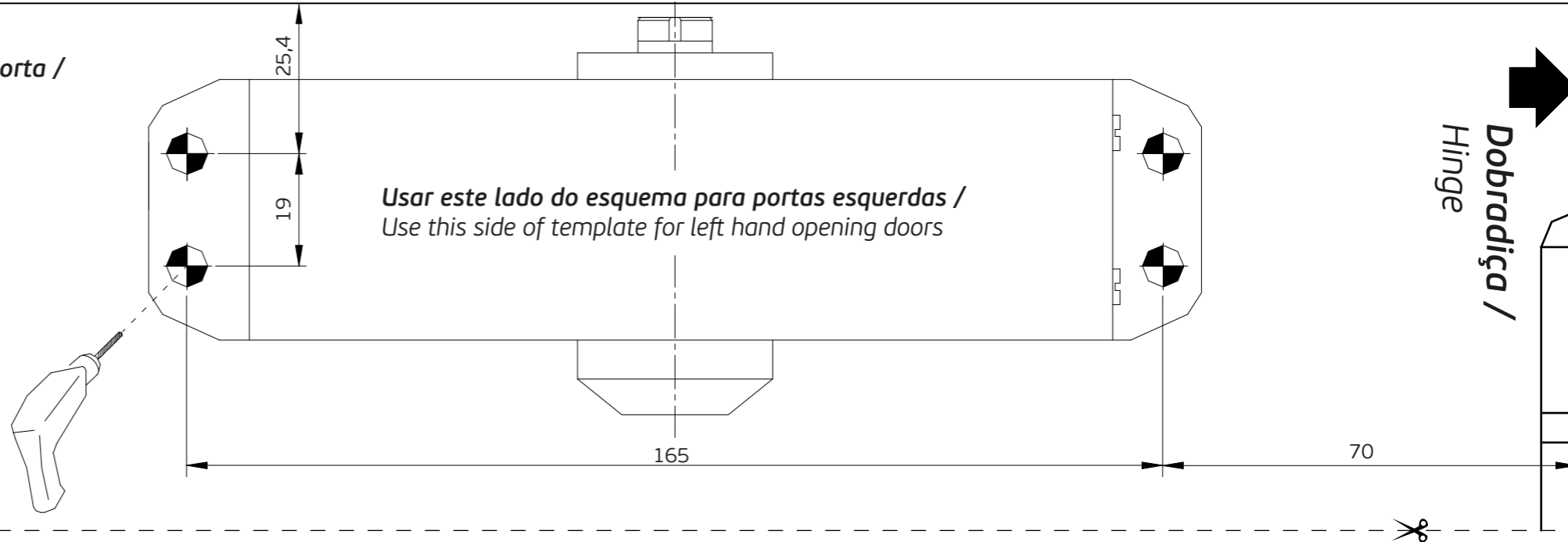

1

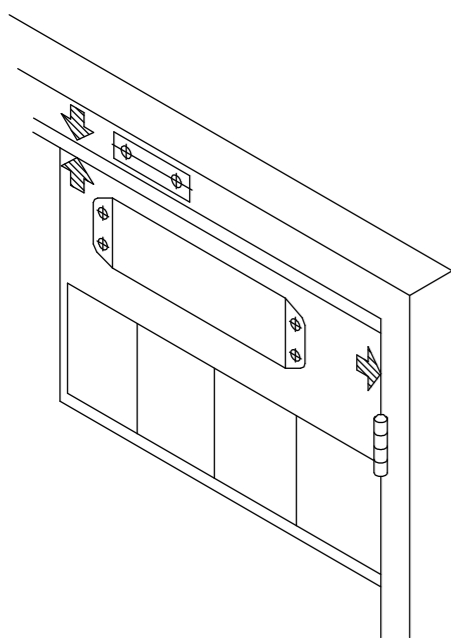

Escolher força necessária. Identificar força no esquema e usá-lo para marcar as furações da mola e do braço /  
Select power requirement. Use template to mark the holes for closer body and arm pivot bracket

2

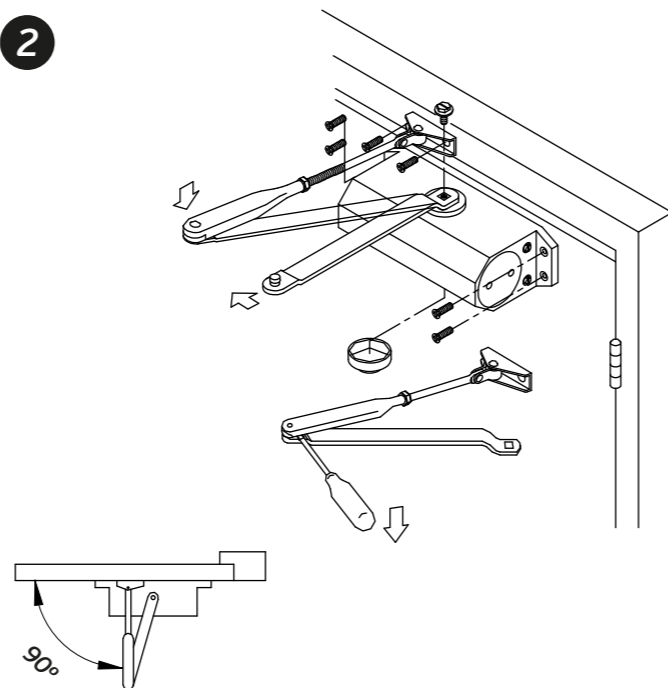

Fixar o braço e a mola de porta, tendo especial atenção à posição do suporte do braço /  
Arm pivot bracket assembly into position and fix the closer body to the marked holes, ensuring that you select the correct shoe position at the frame.

3

Nº2-Velocidade de fecho final /  
Nº2- Latching speed

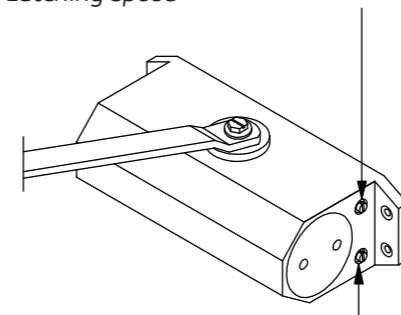

Nº1-Velocidade de fecho /  
Nº1- Closing speed

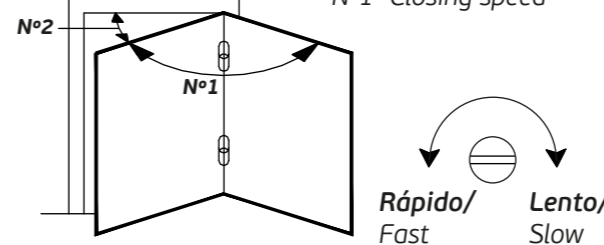

Ajuste de velocidade /  
Speed adjustment

### Manutenção

Os componentes de segurança das molas devem ser vistos regularmente para apertos e sinais de uso (dependendo dos requerimentos). Os parafusos devem ser apertados e os componentes defeituosos devem ser trocados. Adicionalmente, a seguinte manutenção deverá ser executada pelo menos uma vez por ano (dependendo do tipo de porta e utilização):

- Lubrificar todas as partes móveis do braço,
- Verificar as definições de fecho
- Verificar que a porta se move facilmente

Não usar produtos de limpeza que contenham ingredientes corrosivos ou danosos.



J. NEVES & FILHOS  
Comércio e Indústria de Ferragens, S.A.  
Rua das Mimosas, 849/851  
Zona Industrial das Mimosas  
S. Pedro da Cova | Ap. 75  
4424-909 Gondomar PORTUGAL

20

0905 EN 1154:1996/A1:2002/AC:2006

3 8 3 1 1 2

Dangerous substance: None

Força maior de fecho /  
Stronger closing force

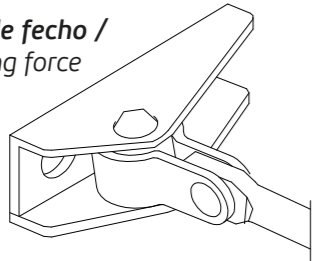

Força menor de fecho /  
Weaker closing force

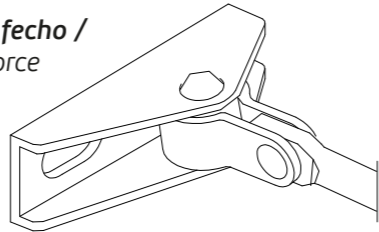

200

Suporte do braço /  
Link shoe

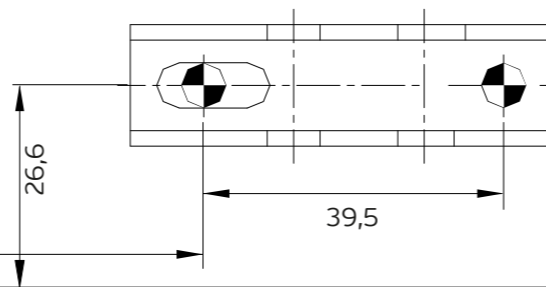

Alinhar pelo aro /  
Align to door frame



Identificar a direcção de abertura da porta /  
Check the opening direction of the door

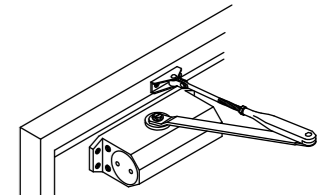

Porta direita /  
Right handed door

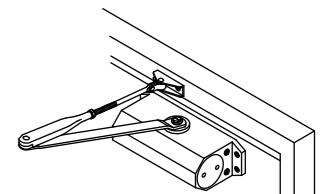

Porta esquerda /  
Left handed door

Alinhar pelo topo da porta /  
Align to top of door



Usar este lado do esquema para portas direitas /  
Use this side of template for right hand opening doors

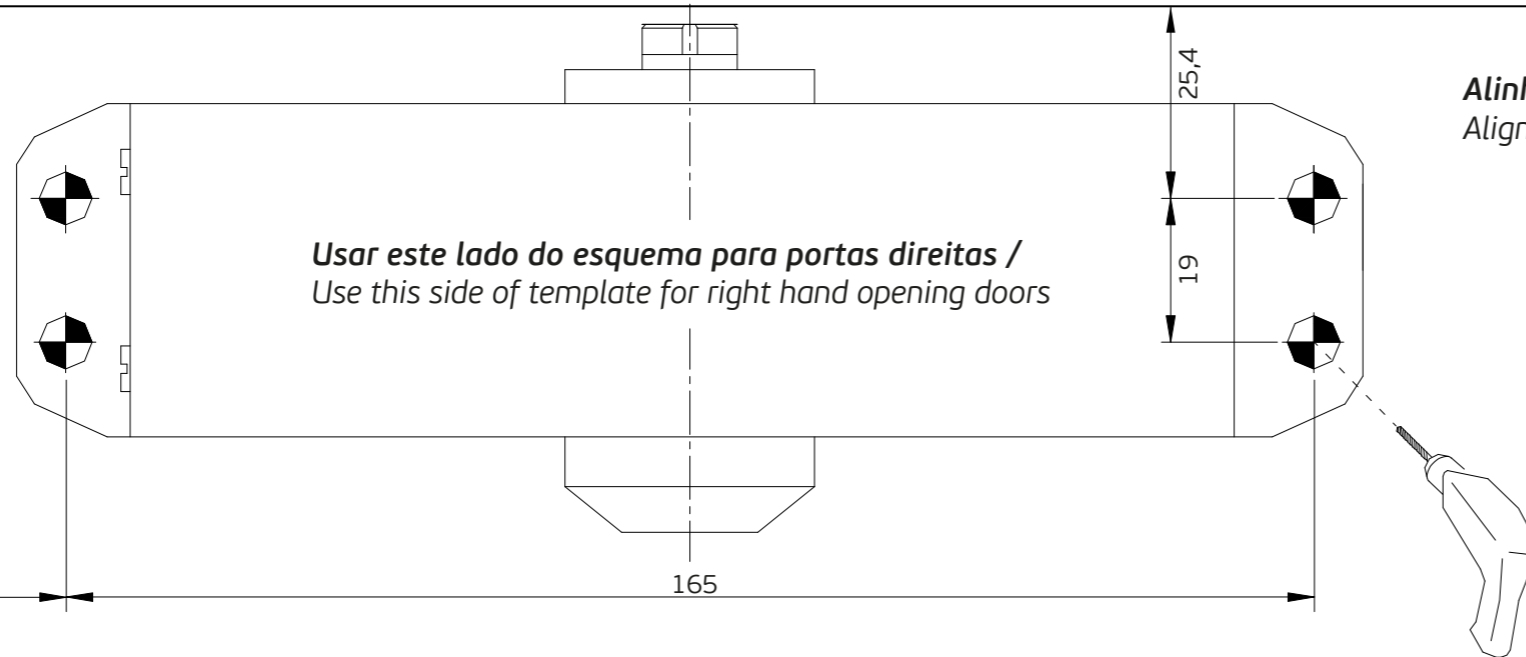

6x

Ø5x30

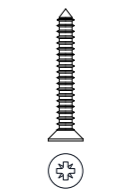

Dobradiça /  
Hinge

70

165

1

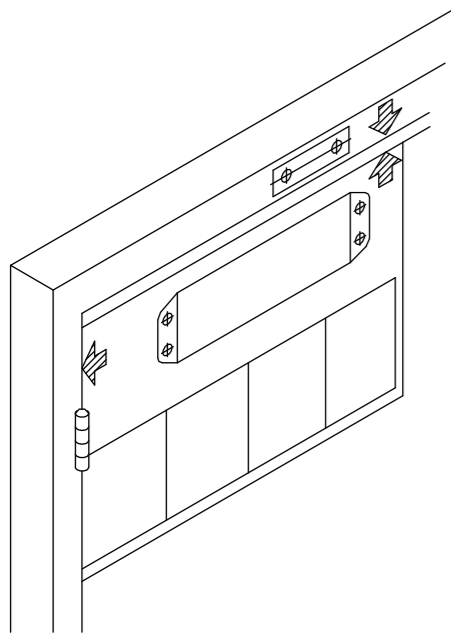

Escolher força necessária. Identificar força no esquema e usá-lo para marcar as furações da mola e do braço /  
Select power requirement. Use template to mark the holes for closer body and arm pivot bracket

2

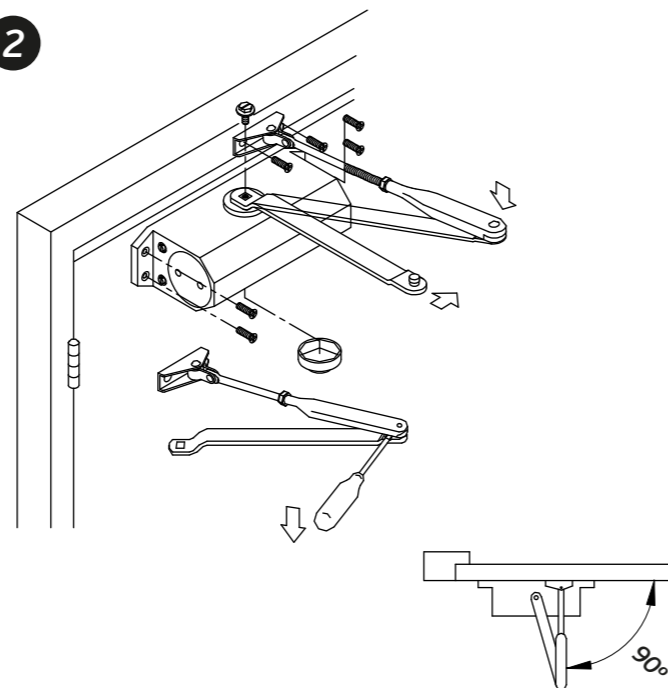

Fixar o braço e a mola de porta, tendo especial atenção à posição do suporte do braço /  
Arm pivot bracket assembly into position and fix the closer body to the marked holes, ensuring that you select the correct shoe position at the frame.

3

Nº2-Velocidade de fecho final /  
Nº2- Latching speed

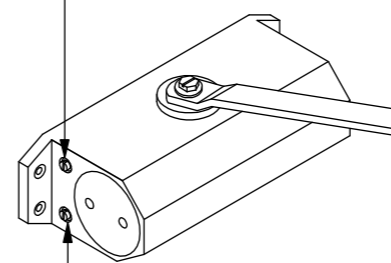

Nº1-Velocidade de fecho /  
Nº1- Closing speed

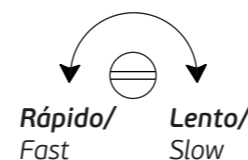

Ajuste de velocidade /  
Speed adjustment

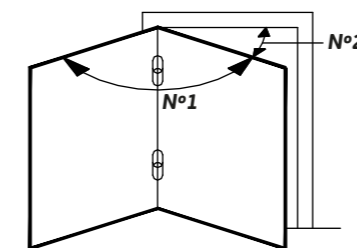

Product maintenance  
Safety-related components of door closers must be checked regularly for tightness and signs of wear (depending on what the requirements are). Fixing screws must be re-tightened and defective components replaced. In addition, the following maintenance work must be carried out at least once a year (depending on the swing leaf door type and extent of use):

- Grease all moving parts on the link arm
- Check the closer settings, e.g. the closing speed
- Check that the door is able to move easily

Do not use any cleaning agents that contain corrosive or damaging ingredients



J. NEVES & FILHOS  
Comércio e Indústria de Ferragens, S.A.  
Rua das Mimosas, 849/851  
Zona Industrial das Mimosas  
S. Pedro da Cova | Ap. 75  
4424-909 Gondomar PORTUGAL

20

0905 EN 1154:1996/A1:2002/AC:2006

3 8 3 1 1 2

Dangerous substance: None